

Description:

Vibracoustics Ltd range of Vi-Flex are fully bonded mounts available in natural, or oil resistant rubber with mild steel or stainless steel metals as standard.

The compact design provides high vertical deflections combined with low lateral stiffness to ensure good all round isolation performance, even at low disturbing frequencies.

Plain fixing holes in the base and a single top threaded hole offer easy installation.



Typical Applications include:

- Fan sets.
- Engine radiators.
- Compressors.
- Instrument panels.
- Small engines.
- Small electric motors.
- Control boxes.
- Gearbox drives.
- Pumps.

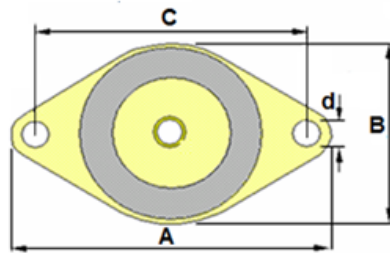
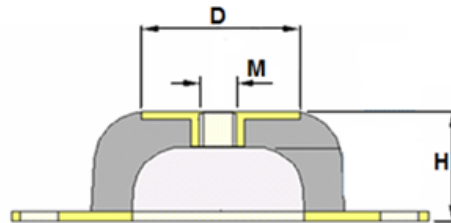

Base Type 'A'

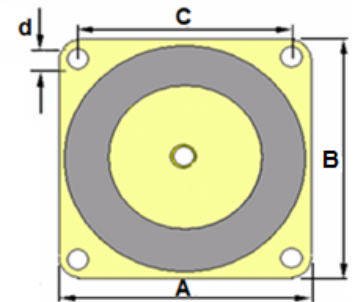

Base Type 'B'

Part No.	Base Type	Dimensions (mm)							Max Load (Kg)		Max Static Deflection (mm)
		∅D	B	C	A	H	∅d	M	N45	N60	
VS4117	A	40*	43	52	64	20*	6.5	M6	4	10	2.0 / 2.5
VS4102	A	30	56	66	85	25	8	M8	20	40	4.8
VS4103	A	45	76	92	114	35	10.5	M10	60	100	6
VS4104	A	50	96	110	136	40	11.5	M10	70	130	8.5
VS4105	A	56	101	124	151	45	11.5	M10	130	220	10
VS4106 **SPO1	A	75	150	170	200	63	14.5	M12	280	500	16
VS4106	B	75	150	120	150	63	14.5	M12	280	500	16
VS4107	B	100	200	160	200	85	14.5	M16	400	860	18

Parts marked with * include dimensions of loose top loading plate supplied with mounting.

Parts marked with ** are a 2 hole type base mount.

